

SYT

系列离心式空调风机

CENTRIFUGAL VENTILATORS



S
Y
T

概述

SYT系列离心式空调风机流量从1000m³/h~40000m³/h, 具有结构紧凑、效率高、噪声低等特点, 是各类柜式中央空调机组、管道式机组及其它暖通、空调、净化、通风设备理想的配套产品。

Outline

SYT series centrifugal air-conditioning ventilators volum ranging from 1000m³/h~40000m³/h, they are characterized by compact construction, high efficiency and low noise. They are the ideal subsidiary equipment for various cabinet central air-conditioning units, tube units and heating, air-conditioning, cleansing and ventilating equipments.

命名方式

SYT系列风机命名方式由风机系列代号、叶轮名义直径、叶轮名义宽度、结构形式组成。

SYT 7 - 7 L

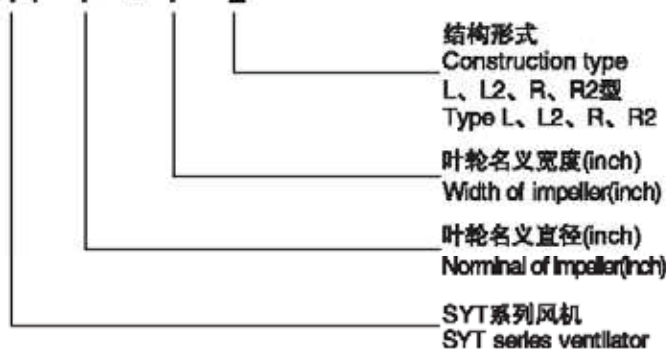

Designation of Products

The nomenclature of SYT series is composed of nominal diameter of impeller and nominal width of impeller.

出口法兰 (Outlet Flange)

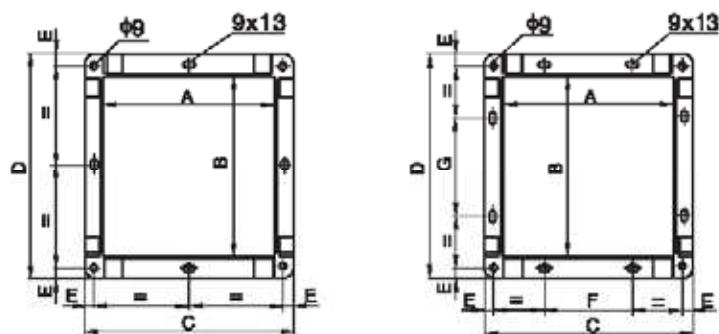

型号 Typ	7-7	8-8	9-7	9-9	10-8	10-10	12-9	12-12	15-11	15-15	18-13	18-18
A	259	287	232	298	265	331	309	395	373	471	430	557
B	228	256	262	262	289	289	341	341	404	404	478	478
C	299	327	272	338	321	387	365	451	429	527	486	613
D	268	296	302	302	345	345	397	397	460	460	534	534
E	10	10	10	10	13	13	13	13	13	13	13	13
F	\	\	\	\	\	\	125	150	145	180	160	200
G	\	\	\	\	\	\	140	140	160	160	180	180

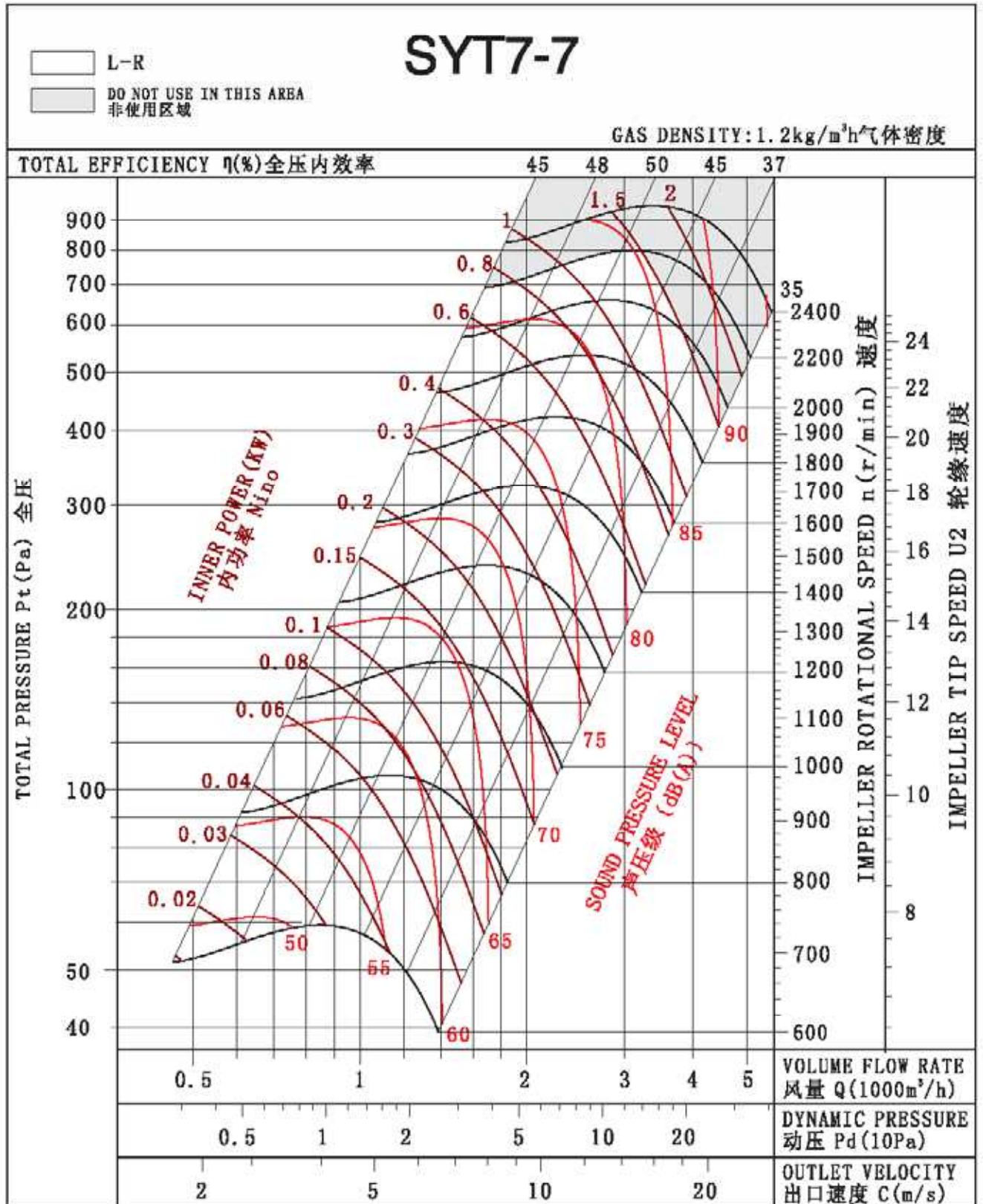

SYT

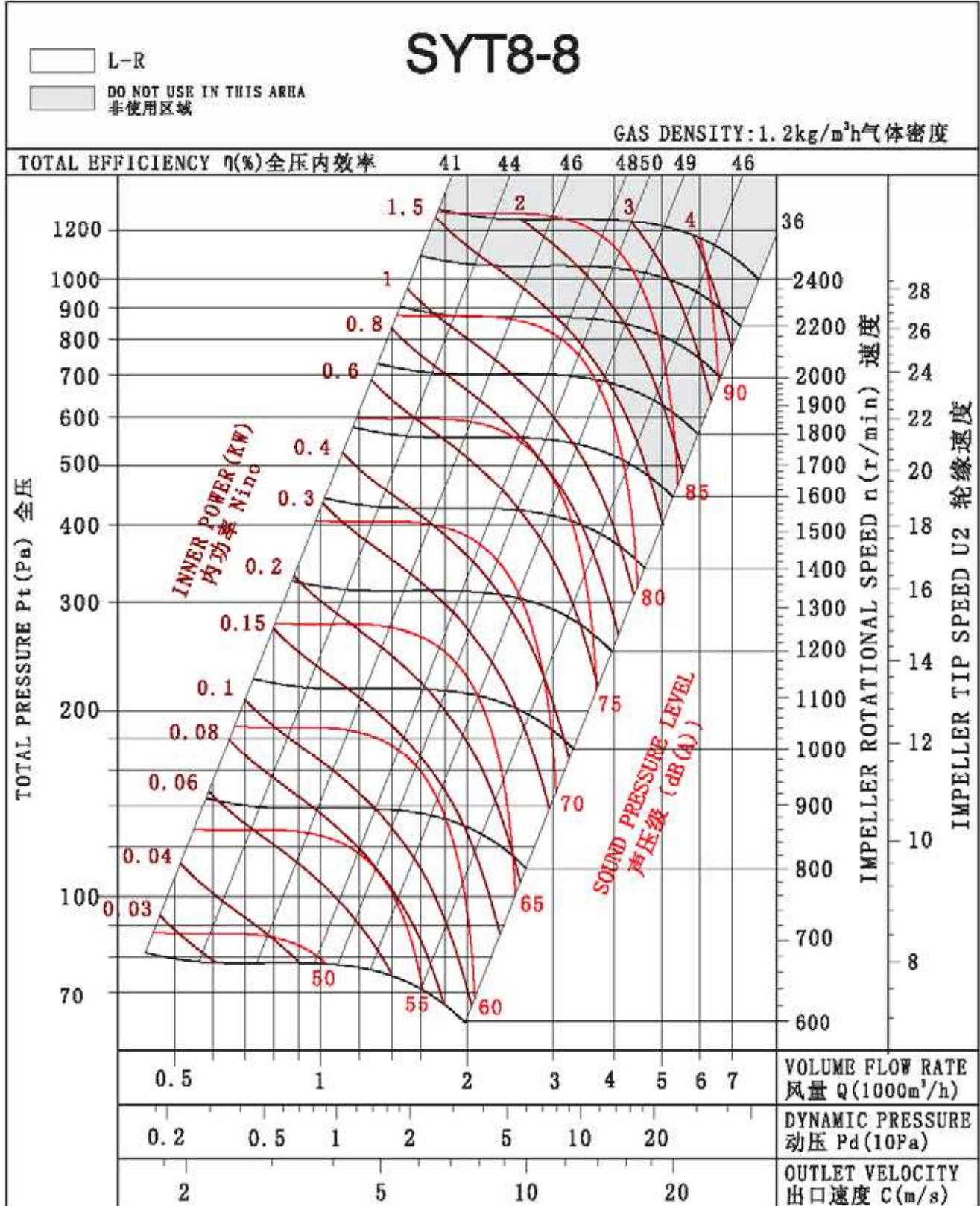

SYT

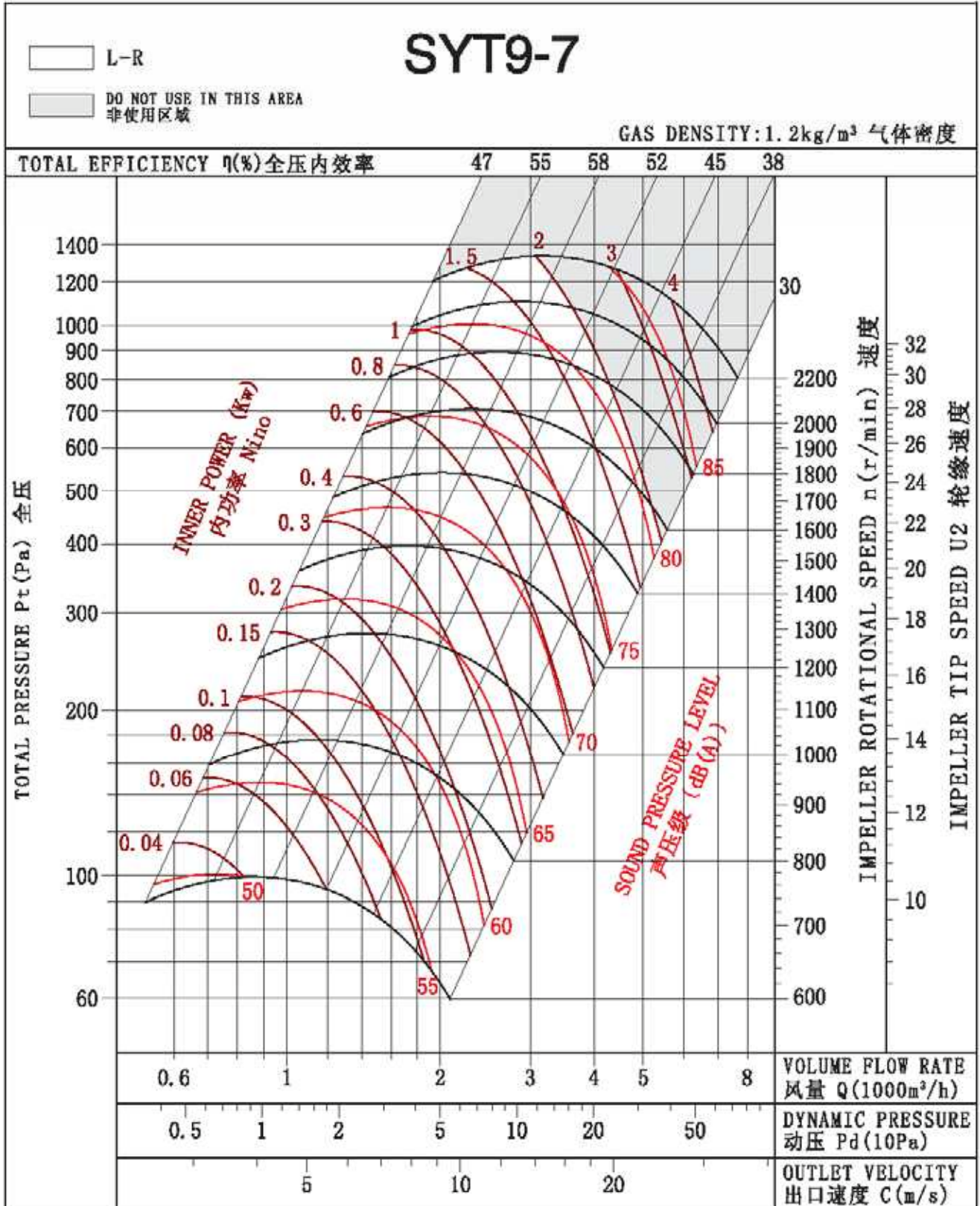

SYT

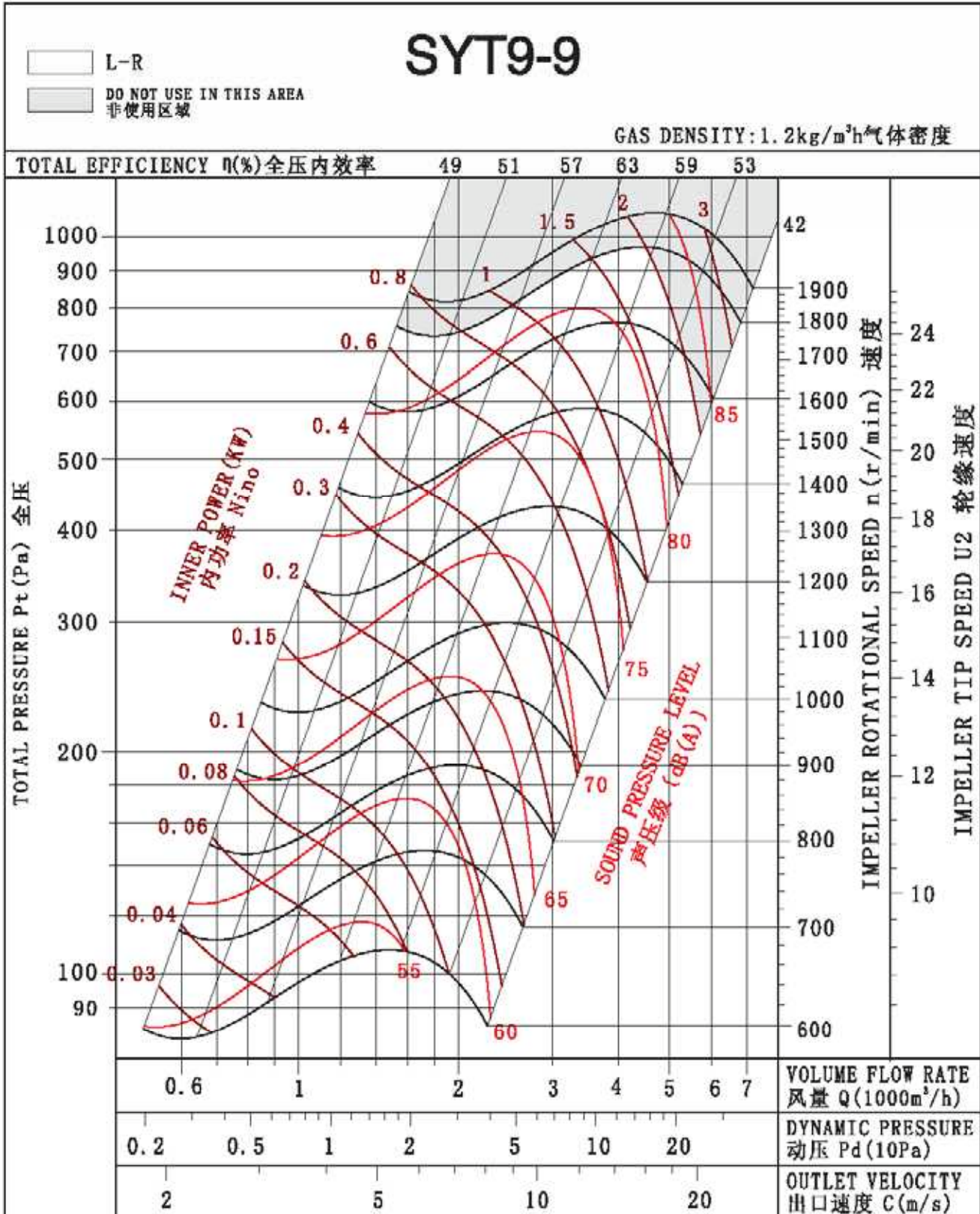

SYT

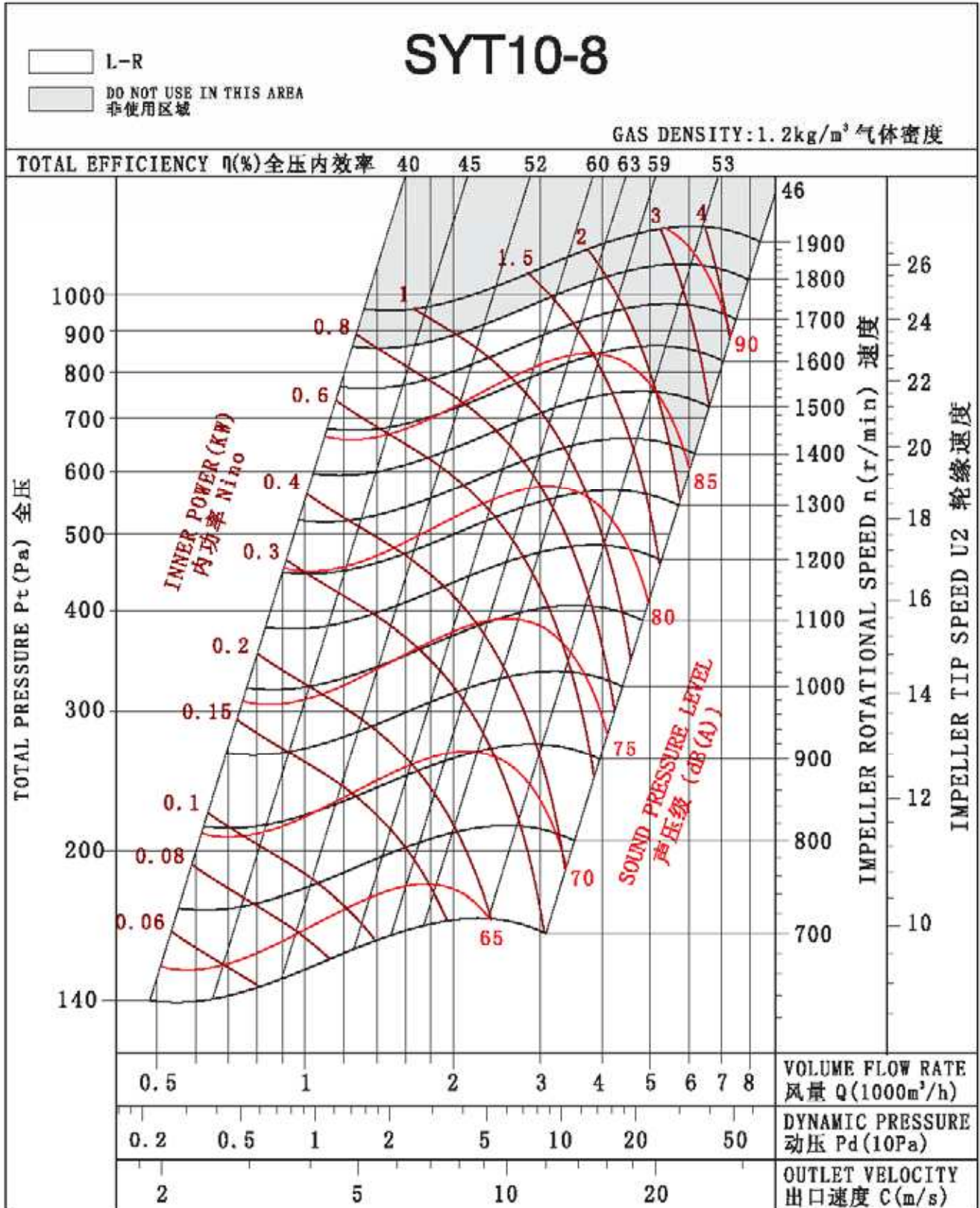

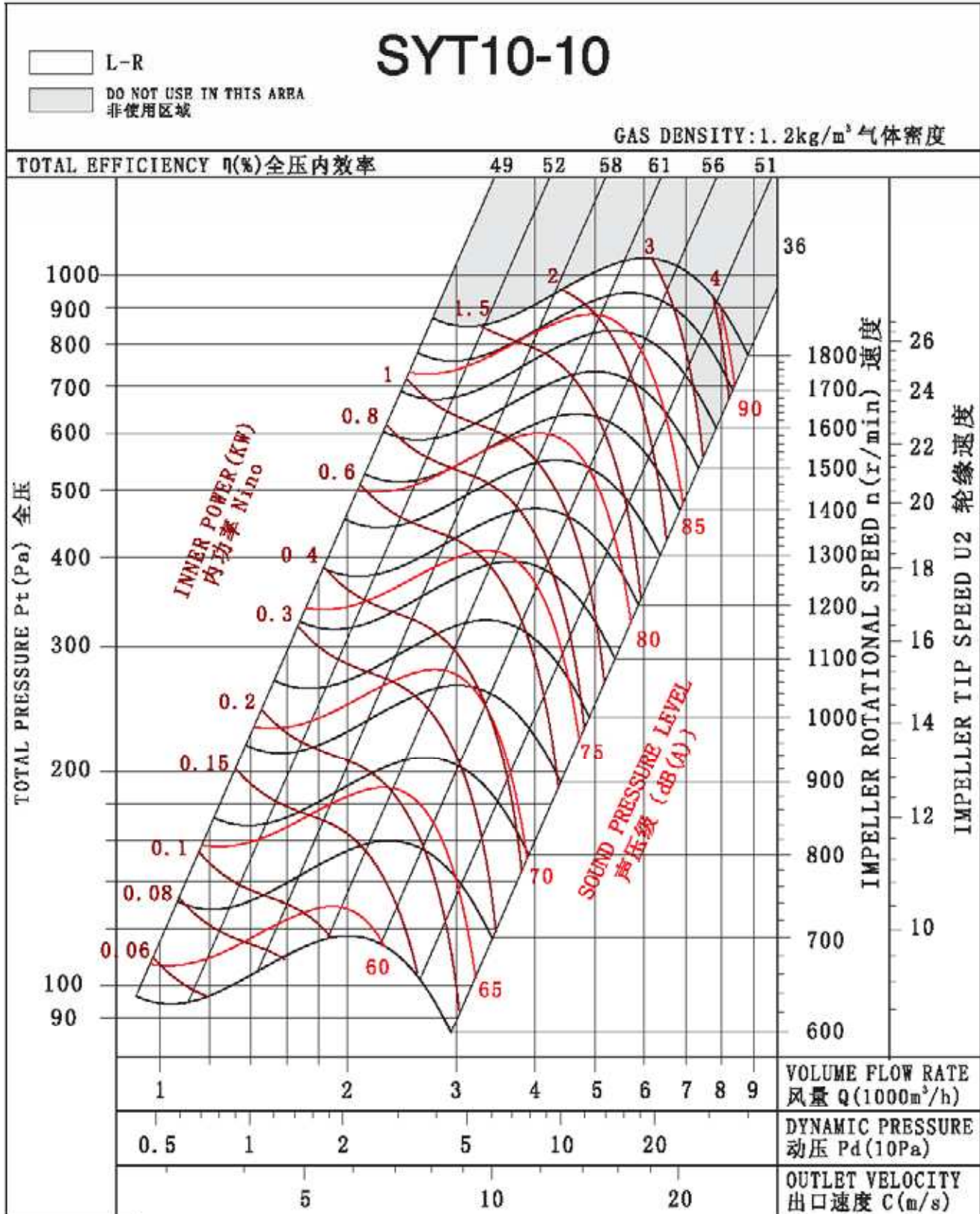

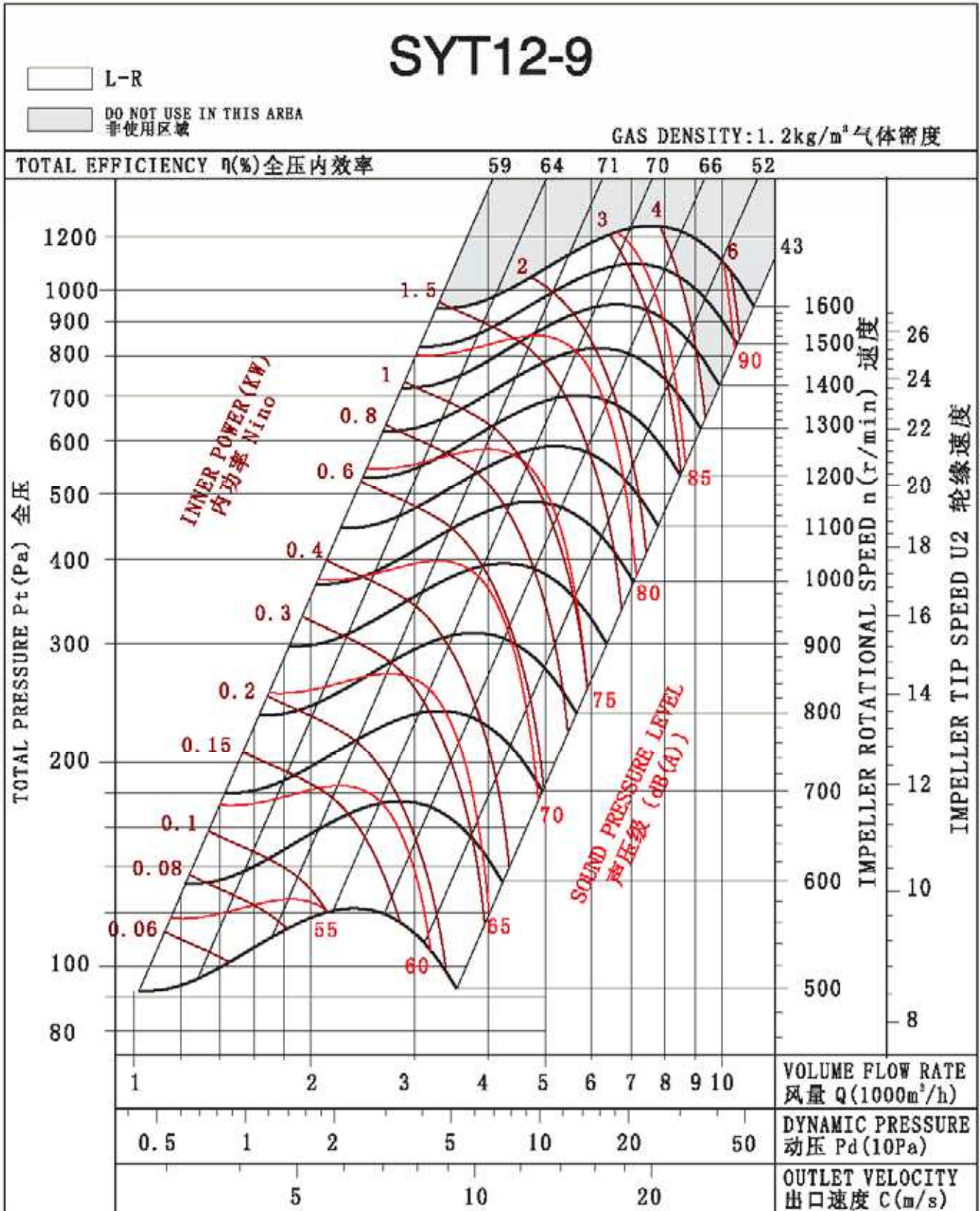

SYT



SYT12-12

L-R
 DO NOT USE IN THIS AREA
 非使用区域

GAS DENSITY: 1.2kg/m³ 气体密度

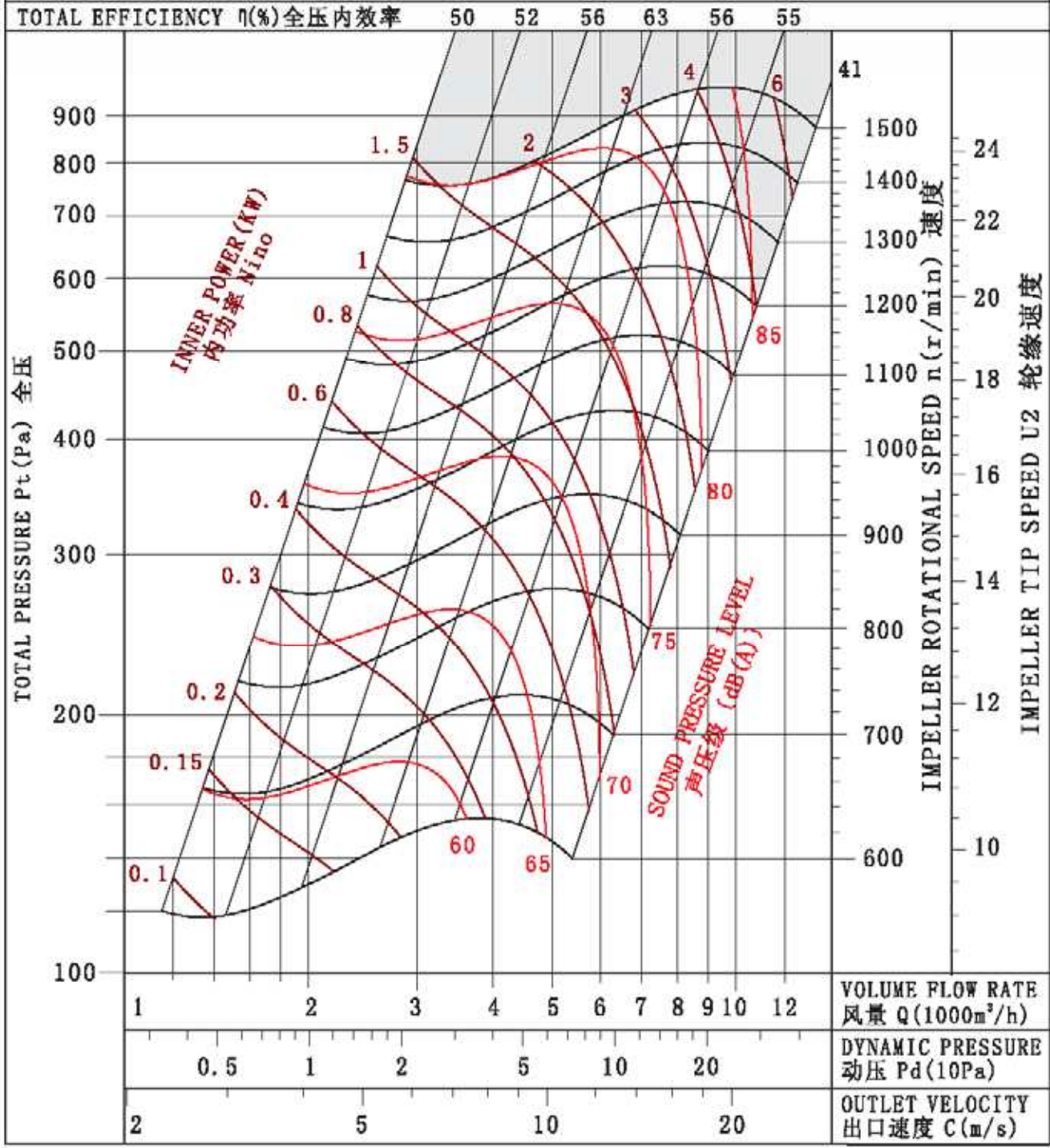

SYT

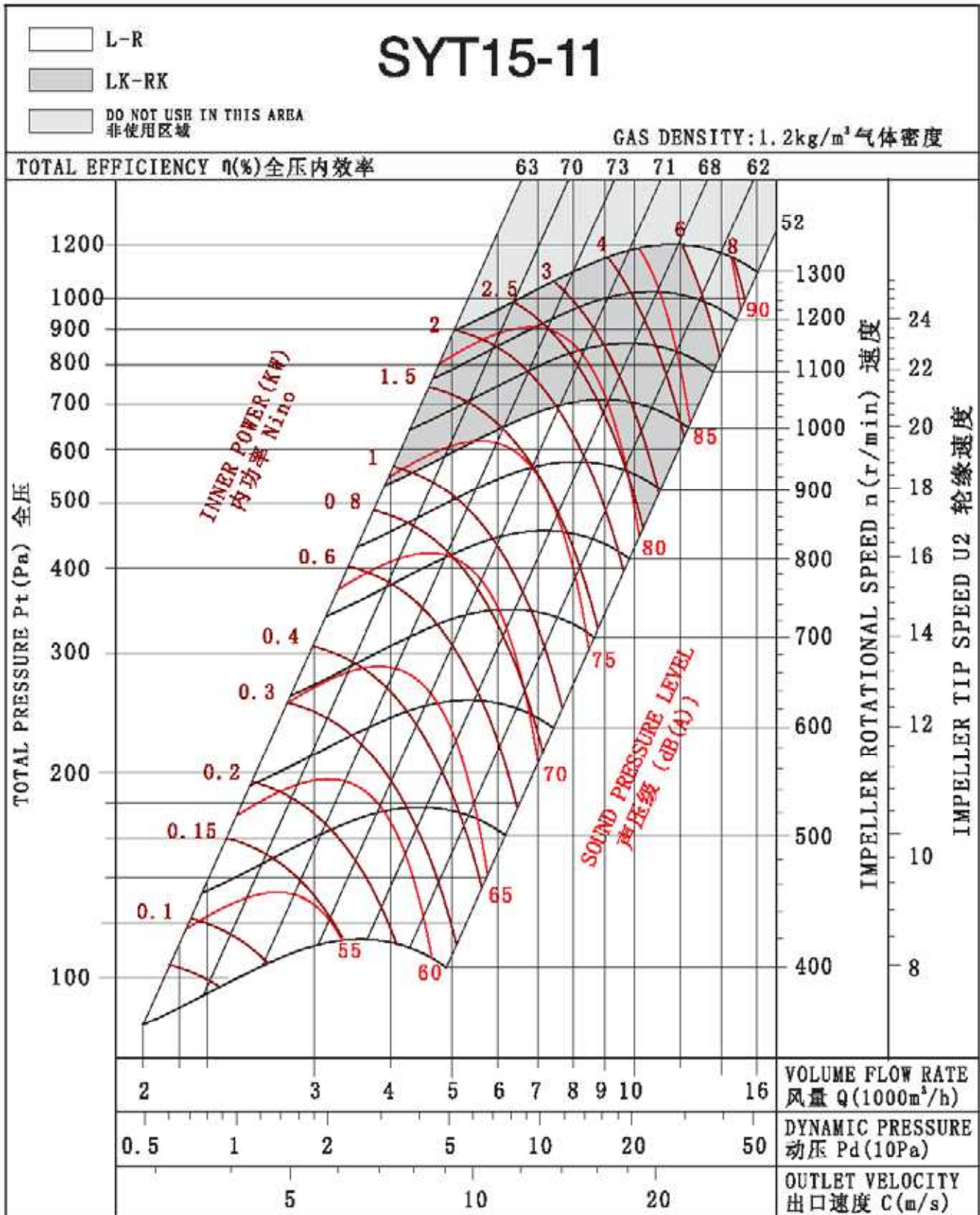

SYT

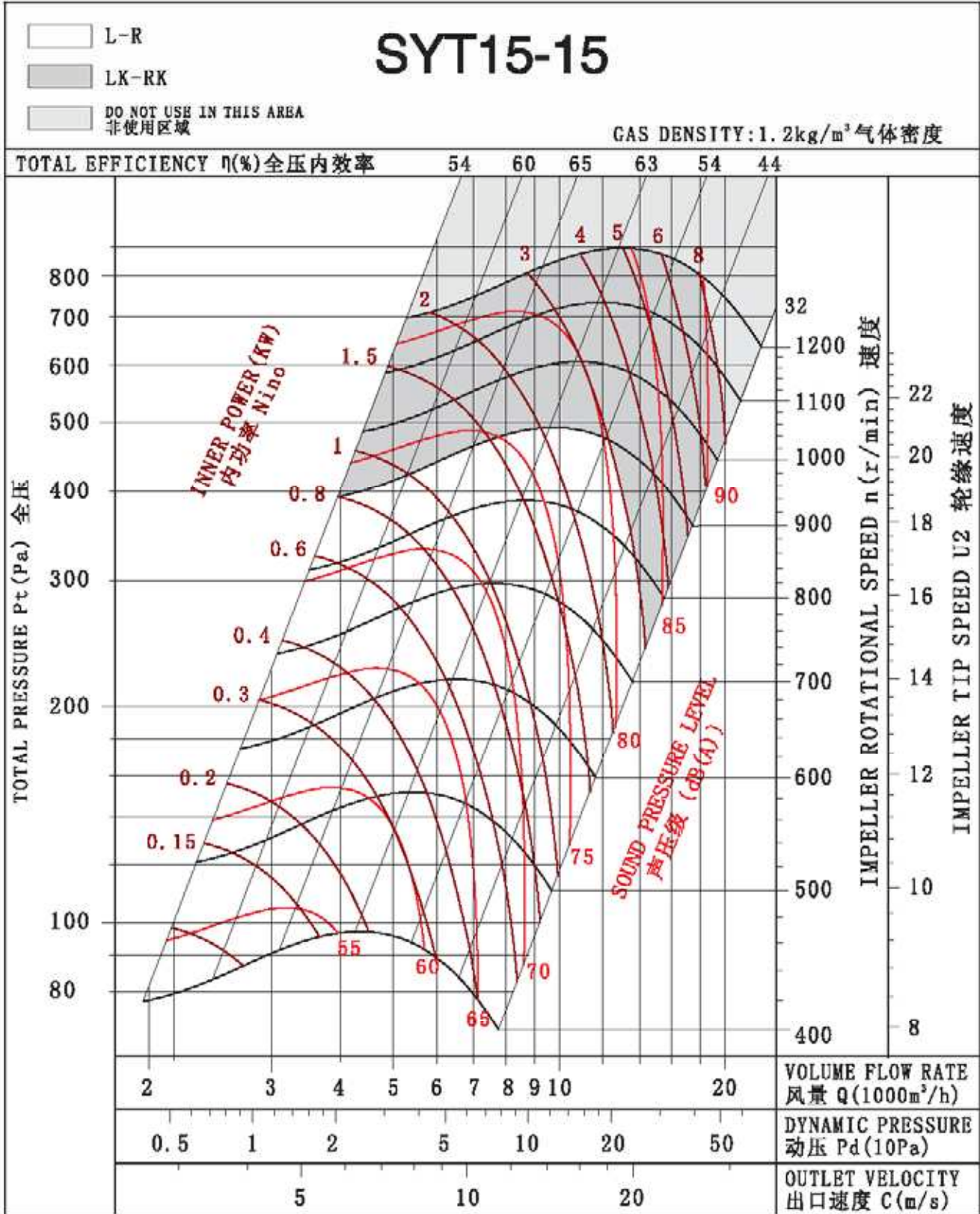

SYT

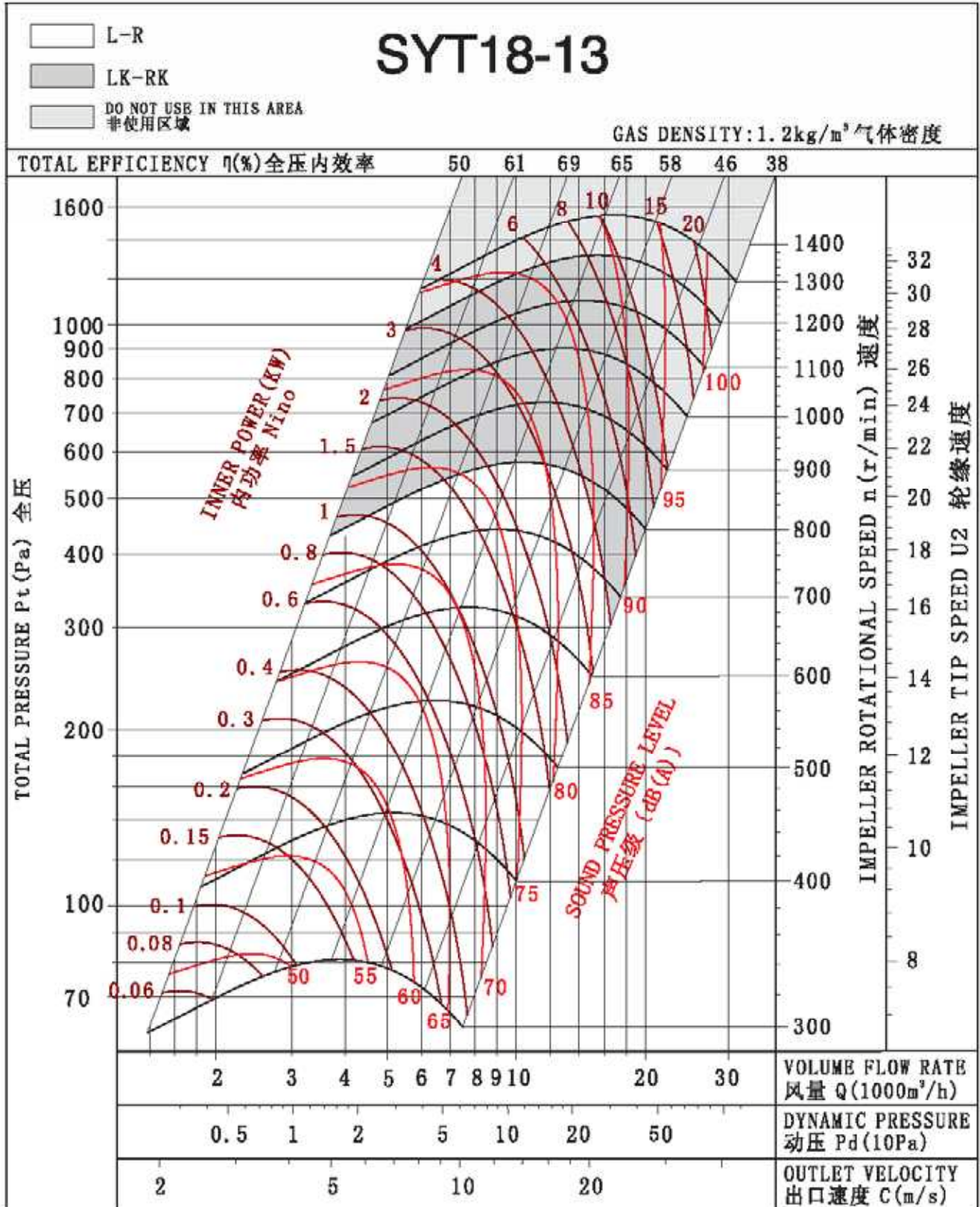

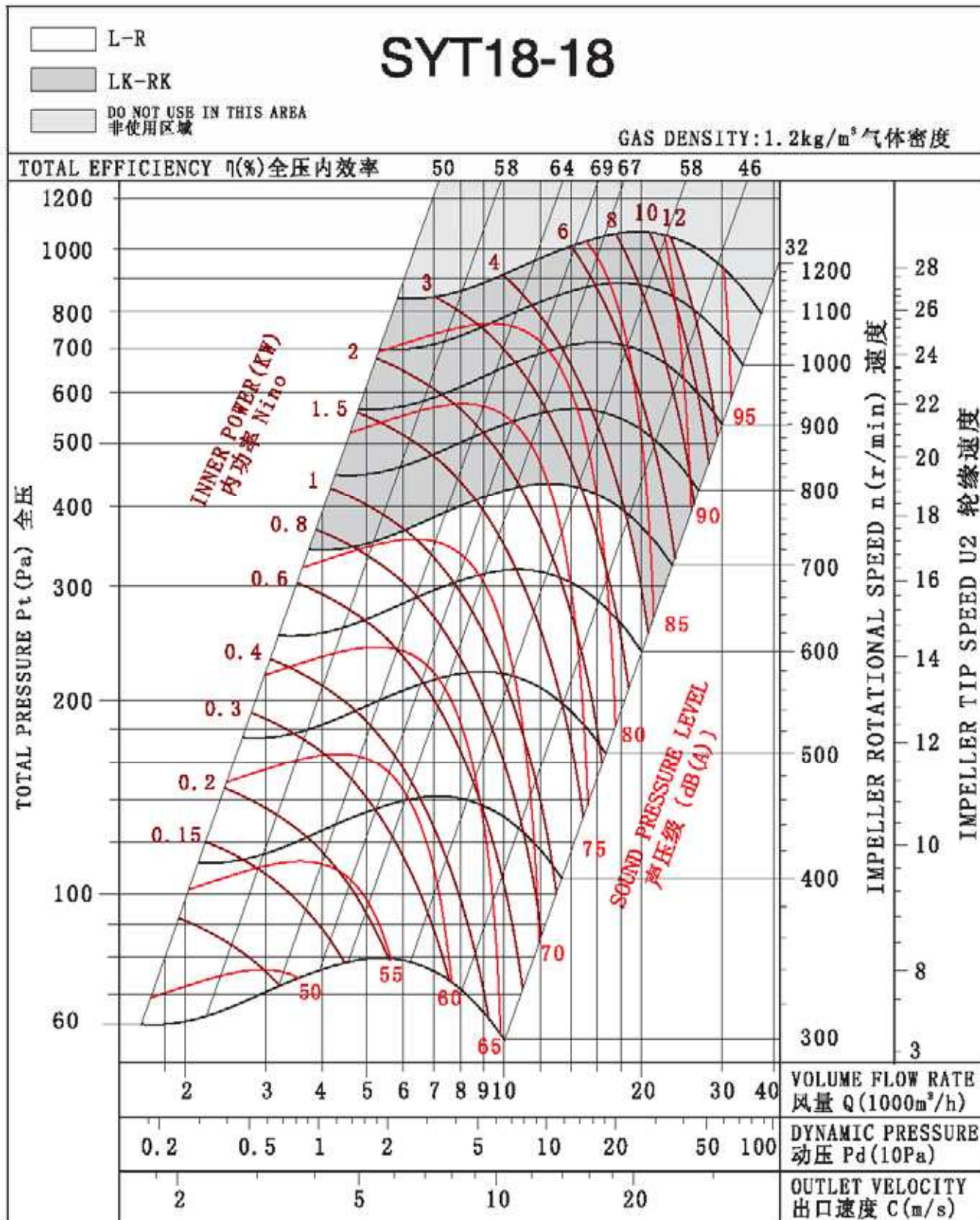

SYT

SYT-L(LK)

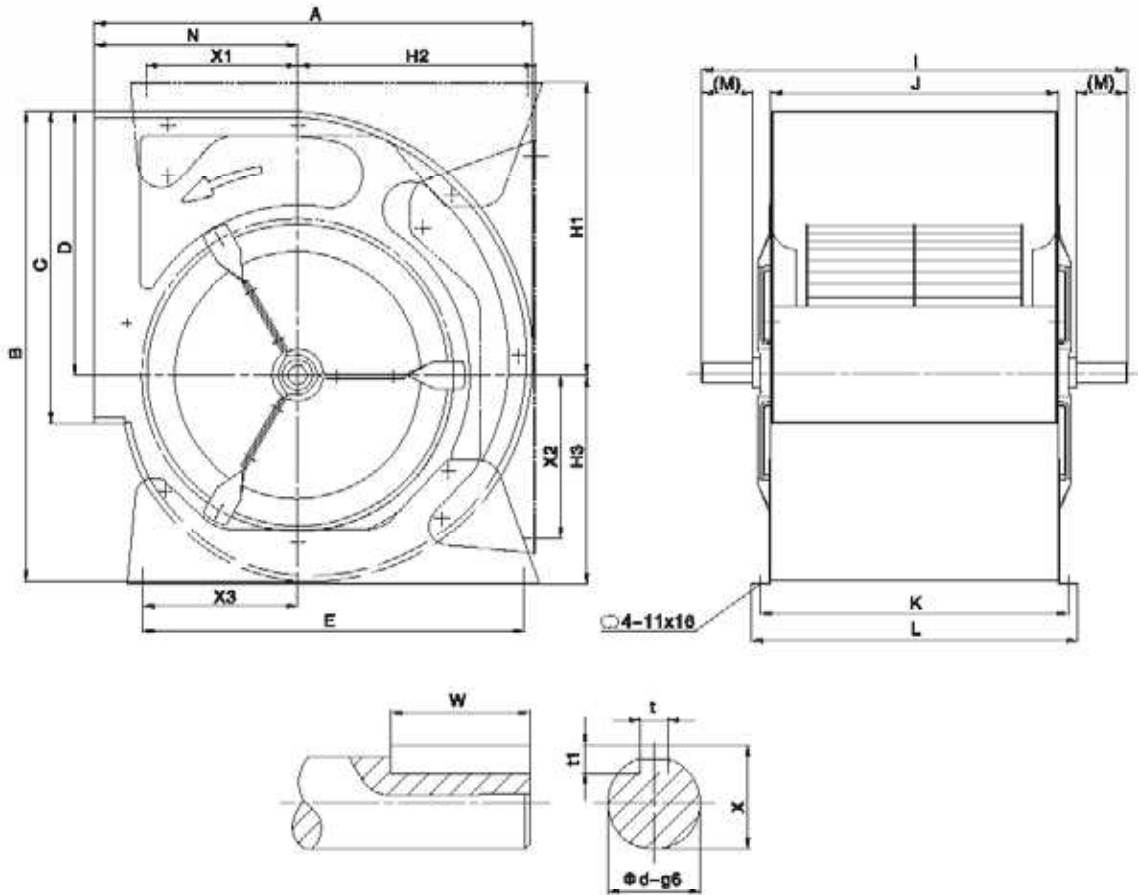

Model	A	B	C	D	E	I	J	K	L	M	N	X	t	t1	W	d	H1	H2	H3	X1	X2	X3
7-7L	312	328	228	192	180	370	259	279	299	32	152	22.5	6	6	30	20	224	164	164	90	90	90
8-8L	346	365	256	216	224	420	287	312	337	43	164	22.5	6	6	40	20	245	164	161	112	112	112
8-7L	360	367	262	215	300	370	232	258	292	45.5	165	22.5	6	6	40	20	253	166	177	118	124	123
8-9L	380	387	262	215	300	447	298	324	348	51	186	22.5	6	6	30	20	253	166	177	118	124	123
10-8L	430	446	289	249	340	409	285	291	315	46.5	203	28	8	7	40	25	287	227	198	138	132	135
10-10L	430	446	289	249	340	490	331	357	381	56	203	28	8	7	55	25	287	227	198	136	132	135
12-9L	491.5	521	341	294	408	464	309	335	369	54	230	28	8	7	40	25	332	266	232	161	153	161
12-12L	491.5	521	341	294	408	564	395	421	445	61	230	28	8	7	60	25	332	266	232	161	153	161
15-11L	569	609	404	342	495	552	373	399	423	66	264	28	8	7	50	25	380	309	272	197	211	201
15-11LK	569	609	404	342	495	670	373	399	423	71.6	264	33	8	7	40	30	380	309	272	197	211	201
15-15L	569	609	404	342	495	650	471	497	521	66	264	28	8	7	60	25	380	309	272	197	211	201
15-15LK	569	609	404	342	495	675	471	497	521	75.3	264	33	8	7	65	30	380	309	272	197	211	201
18-13L	684	739	478	415	608	610	430	466	490	68.5	314	28	8	7	66	25	457	376	340	262	283	278
18-13LK	684	739	478	415	608	610	430	466	490	60.6	314	38	10	8	60	35	457	376	340	262	283	278
18-18L	684	739	478	415	608	740	557	583	607	68	314	28	8	7	65	25	457	376	340	262	283	278
18-18LK	684	739	477	415	608	790	557	583	607	67.1	314	36	10	8	70	35	457	376	340	262	283	278

SYT-R(RK)

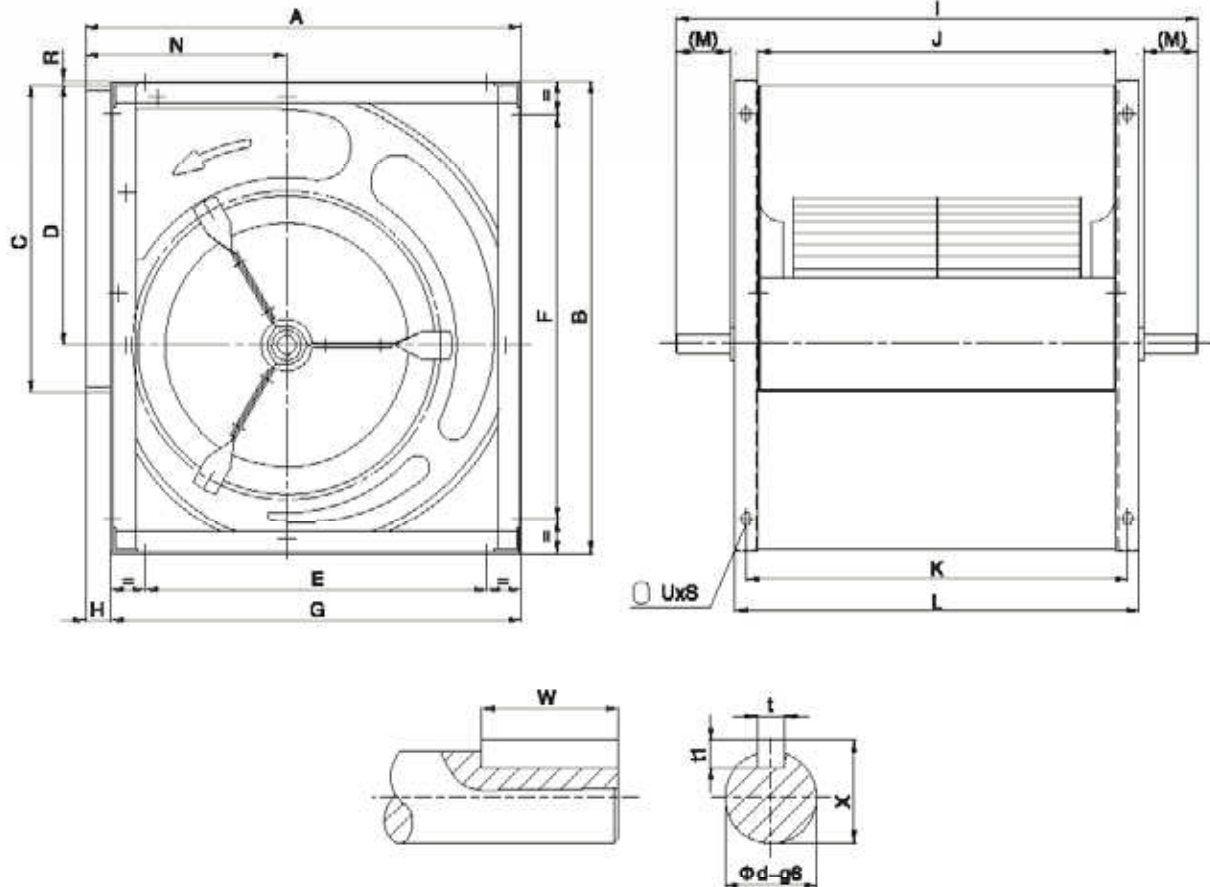

SYT

Model	A	B	C	D	E	F	G	H	I	J	K	L	M	N	R	t	t1	W	X	d	Ux8
7-7R	323	336	228	192	180	180	294	29	420	259	281	299	57	152	6	6	6	40	22.5	20	9x12
8-8R	348	370	258	218	224	224	314	34	490	287	312	337	63	164	3	6	6	50	22.5	20	9x12
9-7R	385	398	262	215	274	324	349	36	388	232	254	272	54.5	185	6	6	6	40	22.5	20	9x12
9-8R	385	398	262	215	274	324	349	38	480	298	320	338	57.5	185	8	8	6	50	22.5	20	9x12
10-8R	431	455	289	249	330	390	395	38	425	265	287	305	58.5	203	6	8	7	40	28	25	11x18
10-10R	431	455	289	249	330	390	395	36	490	331	353	371	56	203	6	8	7	55	28	25	11x16
12-9R	494	527	341	294	371	443	458	36	490	309	339	369	67	230	3	6	7	60	28	25	11x18
12-12R	494	527	341	294	371	443	458	36	600	395	425	455	79	230	3	6	7	40	28	25	11x18
15-11R	575	619	402	343	449	531	539	36	585	373	403	433	82.5	268.7	4	8	7	50	28	25	11x18
15-11RK	575	619	402	343	449	531	539	36	625	373	403	433	99.3	268.7	4	8	7	40	33	30	11x18
15-15R	575	619	402	343	449	531	539	36	685	471	501	531	83.5	268.7	4	8	7	55	28	25	11x18
15-15RK	575	619	402	343	449	531	539	36	725	471	501	531	100.3	268.7	4	8	7	85	33	30	11x18
18-13R	690	751	478	415	544	641	654	38	688	430	470	510	94.5	314	6	8	7	85	28	25	11x18
18-13RK	690	751	478	415	544	641	654	38	688	430	470	510	88.8	314	6	10	8	56	38	35	11x18
18-18R	690	751	478	415	544	641	654	38	790	557	687	637	93	314	6	8	7	86	28	25	11x18
18-18RK	690	751	478	415	544	641	654	38	790	557	687	637	88.8	314	6	10	8	70	38	35	11x18

SYT-L2

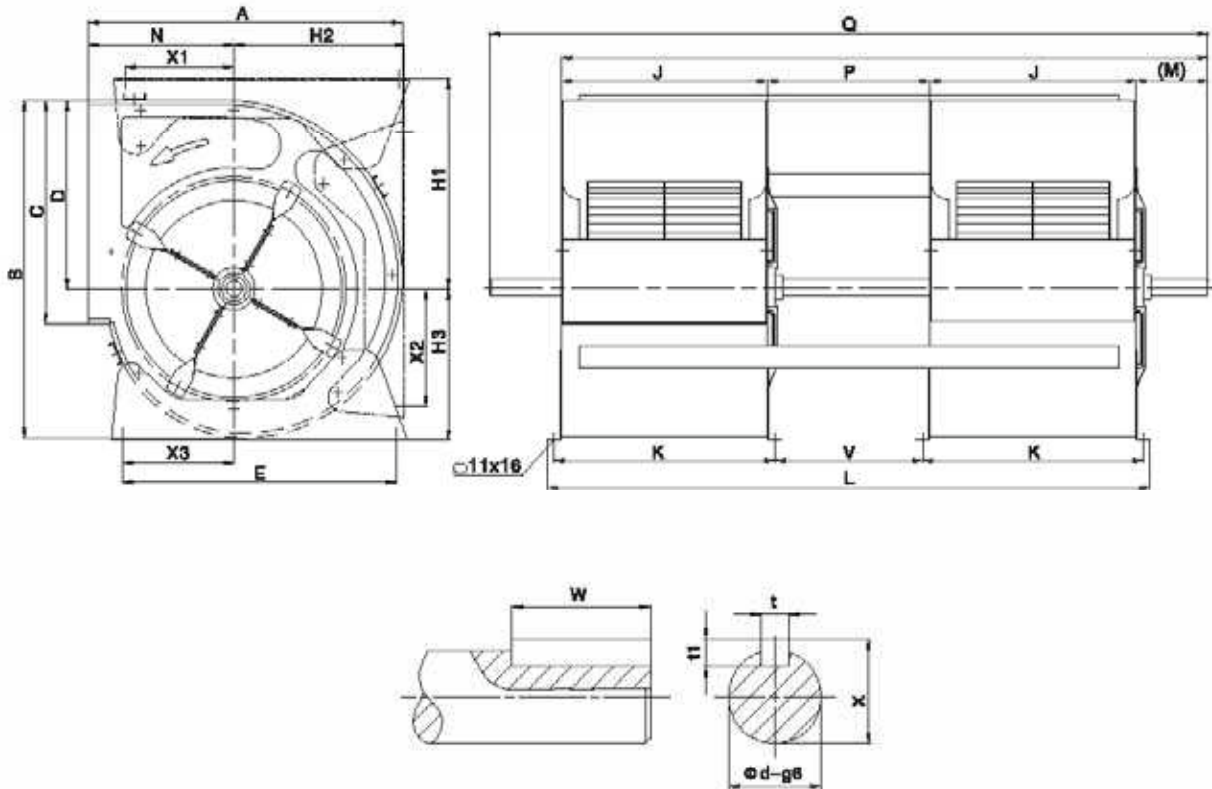

Model	A	B	C	D	E	I	J	K	L	M	N	P	Q	V	X	t	t1	W	d	H1	H	H3	X1	X2	X3
7-7L2	312	328	228	182	180	-	258	279	742	80	152	184	882	164	22.5	8	8	60	20	224	184	164	90	90	90
8-8L2	346	365	256	216	224	-	287	312	838	95	164	214	978	189	22.5	6	6	60	20	245	184	181	112	112	112
9-7L2	380	387	282	215	300	-	232	268	698	90	186	184	828	169	22.5	6	6	60	20	263	199	177	119	124	123
8-9L2	380	387	282	215	300	-	288	324	880	80	186	244	1020	218	28	8	7	60	25	253	189	177	118	124	123
10-8L2	426	443	289	248	340	-	285	291	794	80	203	214	924	188	28	8	7	60	25	287	227	188	138	132	135
10-10L2	426	443	289	248	340	-	331	367	978	90	203	264	1108	238	28	8	7	60	25	287	227	188	138	132	135
12-8L2	491.5	521	341	294	408	-	308	335	912	110	230	244	1082	218	28	8	7	60	25	332	266	232	161	153	161
12-12L2	491.5	521	341	294	408	1224	395	421	1164	110	230	324	-	298	33	8	7	70	30	332	266	232	161	153	161
15-11L2	589	609	404	342	495	1170	373	399	1090	130	264	294	-	268	33	8	7	70	30	380	309	272	197	211	201
15-15L2	589	609	404	342	495	1456	471	497	1376	130	264	384	-	358	33	8	7	70	30	380	309	272	197	211	201
18-13L2	684	739	478	415	608	1343	430	454	1253	140	314	343	-	319	38	10	8	90	35	457	378	340	282	283	278
18-18L2	684	739	478	415	608	1702	557	581	1622	130	314	458	-	434	38	10	8	90	35	457	378	340	282	283	278

注：SYT7-7至SYT12-8系列风机为双出轴
 SYT12-12至SYT18-18系列风机为单出轴

SYT-R2

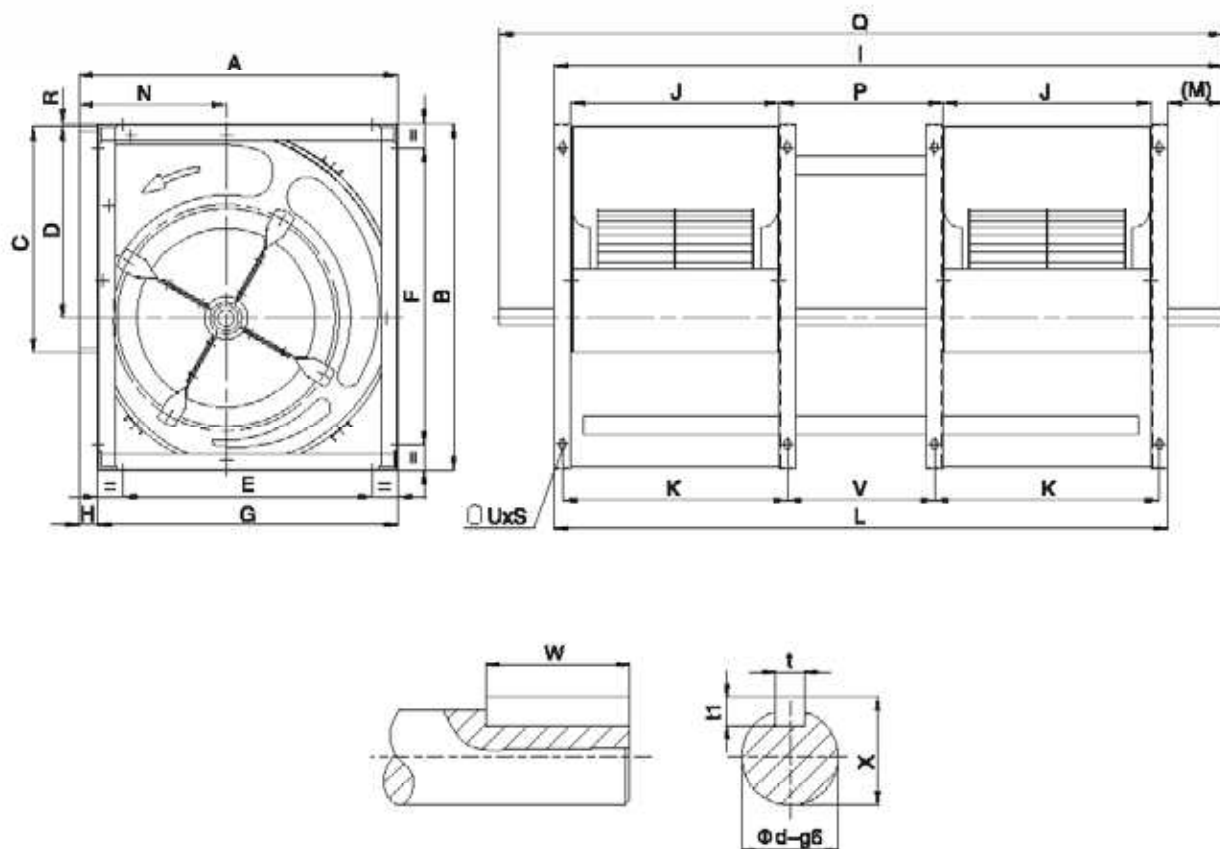

Model	A	B	C	D	E	F	G	H	I	J	K	L	M	N	P	Q	V	R	t	t1	W	X	d	UxS
7-7R2	323	338	228	182	180	180	294	29	-	258	281	742	70	152	184	882	182	8	8	8	60	22.5	20	8x12
8-8R2	348	370	256	216	224	224	314	37	-	287	312	838	70	164	214	978	189	3	6	6	60	22.5	20	8x12
9-7R2	386	399	282	215	274	324	349	38	-	232	264	888	70	185	184	828	182	8	8	6	60	22.5	20	9x12
9-8R2	386	397	282	215	274	324	349	38	-	288	320	880	70	185	244	1020	222	8	8	7	60	28	25	8x12
10-8R2	431	465	288	249	330	380	386	38	-	265	287	784	70	203	214	824	182	7	8	7	60	28	25	11x18
10-10R2	431	465	288	249	330	380	386	38	-	331	363	906	70	203	264	1108	242	7	8	7	60	28	25	11x18
12-8R2	484	527	341	294	371	443	458	36	-	309	339	818	82	230	244	1082	214	3	8	7	60	28	25	11x16
12-12R2	484	527	341	294	371	443	458	38	1274	386	426	1174	100	230	324	-	284	3	8	7	60	33	30	11x16
15-11R2	575	619	402	343	449	531	539	38	1200	373	403	1100	100	288.7	294	-	264	4	8	7	70	33	30	11x16
15-15R2	575	619	402	343	449	531	539	38	1486	471	501	1386	100	288.7	384	-	354	4	8	7	70	33	30	11x16
18-13R2	690	751	478	415	544	641	654	38	1383	430	470	1283	100	314	343	-	303	6	10	8	90	38	35	11x16
18-18R2	690	751	478	415	544	641	654	38	1752	557	597	1652	100	314	458	-	418	6	10	8	90	38	35	11x16

注：SYT7-7至SYT12-9系列风机为双出轴
SYT12-12至SYT18-18系列风机为单出轴

SYT

SYT-L(LK)

		0°				90°				180°			
		左旋LG		右旋RD		左旋LG		右旋RD		左旋LG		右旋RD	
型号 Model	电机 机座号 Motor Frame No.	L	A	B	C	L	A	B	C	L	A	B	C
7-7	63	374	600	400	400	339	620	400	356	359	600	400	396
	71	379	620	400	400	365	660	400	356	365	620	400	396
	80	402	660	400	400	390	700	400	356	390	660	400	396
	90	463	740	400	400	414	740	400	356	454	740	400	396
8-8	63	388	620	450	433	356	660	450	368	370	620	450	437
	71	412	660	450	433	342	660	450	368	396	660	450	437
	80	434	700	450	433	367	700	450	368	420	700	450	437
	90	456	740	450	433	430	780	450	368	444	740	450	437
9-7	71	432	700	400	464	388	700	400	424	411	700	400	434
	80	455	740	400	464	412	740	400	424	439	740	400	434
	90	476	780	400	464	435	780	400	424	462	780	400	434
	100	498	820	400	464	458	820	400	424	486	820	400	434
	112	517	860	400	464	538	920	400	424	508	860	400	434
9-9	71	432	700	439	464	388	700	439	424	414	700	439	434
	80	455	740	439	464	412	740	439	424	439	740	439	434
	90	476	780	439	464	435	780	439	424	462	780	439	434
	100	498	820	439	464	458	820	439	424	486	820	439	434
	112	517	860	439	464	538	920	439	424	508	860	439	434
10-8	71	465	740	465	521	440	780	465	470	439	740	465	487
	80	487	780	465	521	464	820	465	470	464	780	465	487
	90	507	820	465	521	486	860	465	470	487	820	465	487
	100	528	860	465	521	469	860	465	470	510	860	465	487
	112	566	920	465	521	548	960	465	470	551	920	465	487
10-10	80	487	780	490	521	464	820	490	470	464	780	490	487
	90	507	820	490	521	486	860	490	470	487	820	490	487
	100	528	860	490	521	469	860	490	470	510	860	490	487
	112	566	920	490	521	548	960	490	470	551	920	490	487

注: L=风机与电机之间的中心距
 L=Center distance between fan and motor pulley

SYT-L(LK)

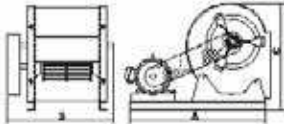
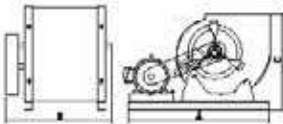
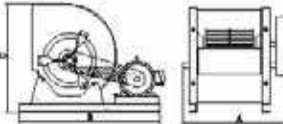
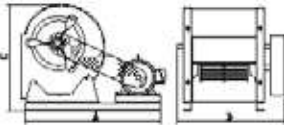
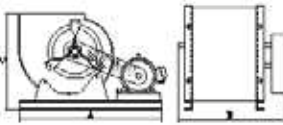
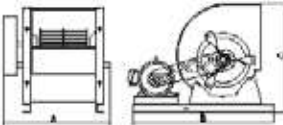
		0°				90°				180°			
左旋LG													
右旋RD													
型号 Model	电机 机座号 Motor Frame Size	L	A	B	C	L	A	B	C	L	A	B	C
12-9	80	652	860	494	599	469	860	494	536	622	860	494	566
	90	691	920	494	599	609	920	494	536	664	920	494	566
	100	592	940	494	599	531	960	494	536	568	940	494	566
	112	614	895	494	599	570	1020	494	536	592	985	494	566
	132	691	1100	494	599	655	1140	494	536	675	1100	494	566
12-12	80	652	860	580	599	469	860	580	536	622	860	580	566
	90	691	920	580	599	609	920	580	536	664	920	580	566
	100	592	940	580	599	531	960	580	536	568	940	580	566
	112	648	1020	580	599	570	1020	580	536	627	1020	580	566
	132	691	1100	580	599	655	1140	580	536	675	1100	580	566
15-11	80	596	920	582	687	533	960	582	613	557	920	582	654
	90	633	980	582	687	572	1020	582	613	598	980	582	654
	100	652	1020	582	687	593	1060	582	613	620	1020	582	654
	112	668	1060	582	687	611	1100	582	613	639	1060	582	654
	132	748	1180	582	687	674	1200	582	613	725	1180	582	654
15-15	80	596	920	680	687	533	960	680	613	557	920	680	654
	90	633	980	680	687	572	1020	680	613	598	980	680	654
	100	652	1020	680	687	593	1060	680	613	620	1020	680	654
	112	668	1060	680	687	611	1100	680	613	639	1060	680	654
	132	748	1180	680	687	674	1200	680	613	725	1180	680	654
18-13	90	729	1100	640	821	639	1140	640	730	684	1100	640	795
	100	747	1140	640	821	659	1180	640	730	705	1140	640	795
	112	762	1180	640	821	704	1250	640	730	723	1180	640	795
	132	838	1300	640	821	765	1350	640	730	806	1300	640	795
	160	884	1400	640	821	814	1450	640	730	858	1400	640	795
18-18	90	729	1100	770	821	639	1140	770	730	684	1100	770	795
	100	747	1140	770	821	659	1180	770	730	705	1140	770	795
	112	762	1180	770	821	704	1250	770	730	723	1180	770	795
	132	791	1250	770	821	765	1350	770	730	757	1250	770	795
	160	884	1400	770	821	814	1450	770	730	858	1400	770	795

注: L=风机与电机之间的中心距
L=Center distance between fan and motor pulley

SYT-R(RK)

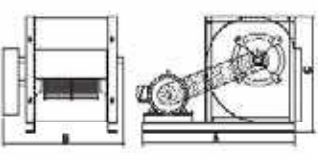
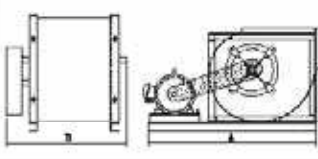
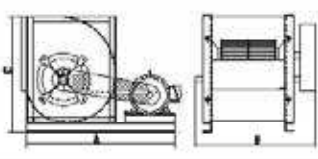
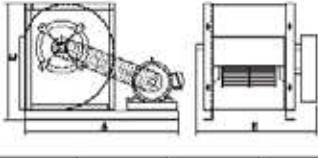
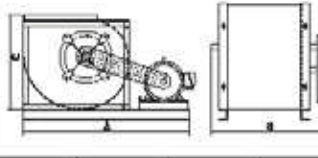
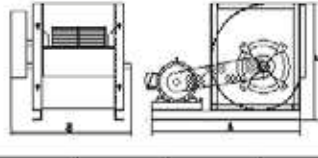
		0°				90°				180°			
左旋LG													
右旋RD													
型号 Model	电机 机座号 Motor Frame Size	L	A	B	C	L	A	B	C	L	A	B	C
7-7	63	366	600	398	376	334	620	398	363	355	600	398	376
	71	372	620	398	376	361	660	398	363	402	660	398	376
	80	396	660	398	376	385	700	398	363	428	700	398	376
	90	458	740	398	376	409	740	398	363	453	740	398	376
8-8	63	381	620	484	410	352	660	484	383	364	620	484	410
	71	405	660	484	410	378	700	484	383	391	660	484	410
	80	428	700	484	410	402	740	484	383	417	700	484	410
	90	450	740	484	410	426	780	484	383	441	740	484	410
9-7	71	423	700	418	439	382	700	418	425	414	700	418	439
	80	447	740	418	439	406	740	418	425	439	740	418	439
	90	469	780	418	439	429	780	418	425	462	780	418	439
	100	492	820	418	439	452	820	418	425	486	820	418	439
9-9	112	512	860	418	439	532	920	418	425	508	860	418	439
	71	423	700	490	439	382	700	490	425	414	700	490	439
	80	447	740	490	439	406	740	490	425	439	740	490	439
	90	469	780	490	439	429	780	490	425	462	780	490	439
	100	492	820	490	439	452	820	490	425	486	820	490	439
10-8	112	512	860	490	439	532	920	490	425	508	860	490	439
	71	454	740	455	495	435	780	455	471	440	740	455	495
	80	477	780	455	495	458	820	455	471	464	780	455	495
	90	498	820	455	495	480	860	455	471	487	820	455	495
	100	520	860	455	495	522	920	455	471	511	860	455	495
10-10	112	559	920	455	495	542	960	455	471	551	920	455	495
	80	477	780	520	495	458	820	520	471	464	780	520	495
	90	498	820	520	495	480	860	520	471	487	820	520	495
	100	520	860	520	495	522	920	520	471	511	860	520	495
	112	559	920	520	495	542	960	520	471	551	920	520	495

注: L=风机与电机之间的中心距
 L=Center distance between fan and motor pulley

SYT-R(RK)

SYT

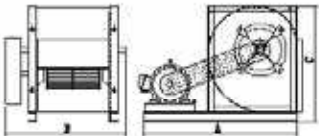
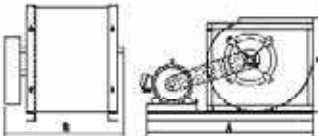
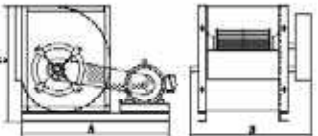
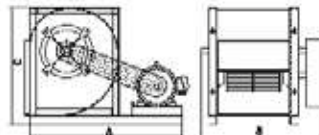
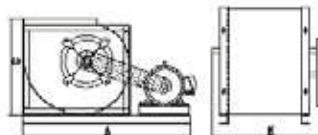
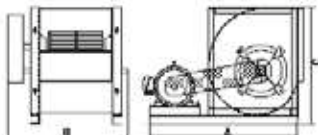
		0°				90°				180°			
													
													
型号 Model	电机 机座型号 Motor Frame Size	L	A	B	C	L	A	B	C	L	A	B	C
12-9	80	566	860	525	573	521	920	525	537	549	860	525	573
	90	606	920	525	573	504	920	525	537	591	920	525	573
	100	608	940	525	573	545	980	525	537	614	940	525	573
	112	632	895	525	573	564	1020	525	537	654	1020	525	573
	132	711	1100	525	573	649	1140	525	537	702	1100	525	573
12-12	80	566	860	615	573	521	920	615	537	549	860	615	573
	90	606	920	615	573	504	920	615	537	591	920	615	573
	100	608	940	615	573	545	980	615	537	594	940	615	573
	112	666	1020	615	573	564	1020	615	537	654	1020	615	573
	132	711	1100	615	573	649	1140	615	537	702	1100	615	573
15-11	80	582	920	615	661	546	980	615	615	577	940	615	661
	90	621	980	615	661	567	1020	615	615	598	980	615	661
	100	641	1020	615	661	587	1060	615	615	620	1020	615	661
	112	658	1060	615	661	605	1100	615	615	640	1060	615	661
	132	739	1180	615	661	689	1200	615	615	725	1180	615	661
15-15	80	582	920	715	661	546	980	715	615	577	940	715	661
	90	621	980	715	661	567	1020	715	615	598	980	715	661
	100	641	1020	715	661	587	1060	715	615	620	1020	715	661
	112	658	1060	715	661	605	1100	715	615	640	1060	715	661
	132	739	1180	715	661	689	1200	715	615	725	1180	715	661
18-13	90	713	1100	696	791	634	1140	696	730	681	1100	696	791
	100	732	1140	696	791	672	1200	696	730	702	1140	696	791
	112	748	1180	696	791	698	1250	696	730	740	1200	696	791
	132	826	1300	696	791	759	1350	696	730	804	1300	696	791
	160	874	1400	696	791	808	1450	696	730	856	1400	696	791
18-18	90	713	1100	820	791	634	1140	820	730	681	1100	820	791
	100	732	1140	820	791	672	1200	820	730	702	1140	820	791
	112	748	1180	820	791	698	1250	820	730	740	1200	820	791
	132	799	1250	820	791	759	1350	820	730	804	1300	820	791
	160	874	1400	820	791	808	1450	820	730	856	1400	820	791

注：L=风机与电机之间的中心距
L=Center distance between fan and motor pulley

SYT系列风机运行极限

SYT Series Ventilator Operational Limits

			7-7	8-8	9-7	9-9	10-8	10-10	12-9	12-12	15-11	15-15	18-13	18-18
极限吸收功率 Max. absorbed power	L-R	Kw	1	1.5	2	2	2	3	4	4	2.5	3	4	4
	LK-RK	Kw	/	/	/	/	/	/	/	/	6	8	10	12
	L2-R2	Kw	2	3	4	4	4	6	8	8	12	16	20	24
极限转速 Max.R.P.M	L-R	rpm	2200	2200	2200	1800	1800	1800	1600	1500	1000	900	800	700
	LK-RK	rpm	/	/	/	/	/	/	/	/	1300	1200	1200	1100
	L2-R2	rpm	2200	2200	2200	1800	1800	1800	1600	1500	1300	1200	1200	1100
极限温度 (最低-20℃) Air Temperature Limits (Min-20℃)	L-R	Max.℃	85	85	85	85	85	85	85	85	85	85	85	85
	L2-R2	Max.℃	85	85	85	85	85	85	85	85	85	85	85	85
轴承额定动载荷 Bearing Dynamic Load	L-R	N	12800	12800	12800	12800	14000	14000	14000	14000	14000	14000	14000	14000
	LK-RK	N	/	/	/	/	/	/	/	/	19500	19500	25700	25700
	L2-R2	N	12800	12800	12800	12800	14000	14000	14000	19500	19500	19500	25700	25700
风机重量 Fan weight	L	Kg	6	7	8	9.5	10	11	15.2	18.2	21.2	24.7	32.4	39.6
	R	Kg	8.5	9.5	10.2	11.4	12.3	13.2	19.1	22	25.1	29.4	39.6	45.5
	LK	Kg	/	/	/	/	/	/	/	/	24.5	28.2	38.6	45.8
	RK	Kg	/	/	/	/	/	/	/	/	28.5	32.8	45.8	51.7
	L2	Kg	14	15.6	17.9	21.7	22.2	25.3	33.9	40.6	47.6	54.3	69.3	84.6
	R2	Kg	20	24	25.8	29.7	29.7	34.1	50	56	63	74.8	100.1	116.3